

# IMMERSION™

## LED Display Lighting

Refrigerated Vertical Cases  
RV40 Series



a product of  
**ecomagination**™

# LED Lights

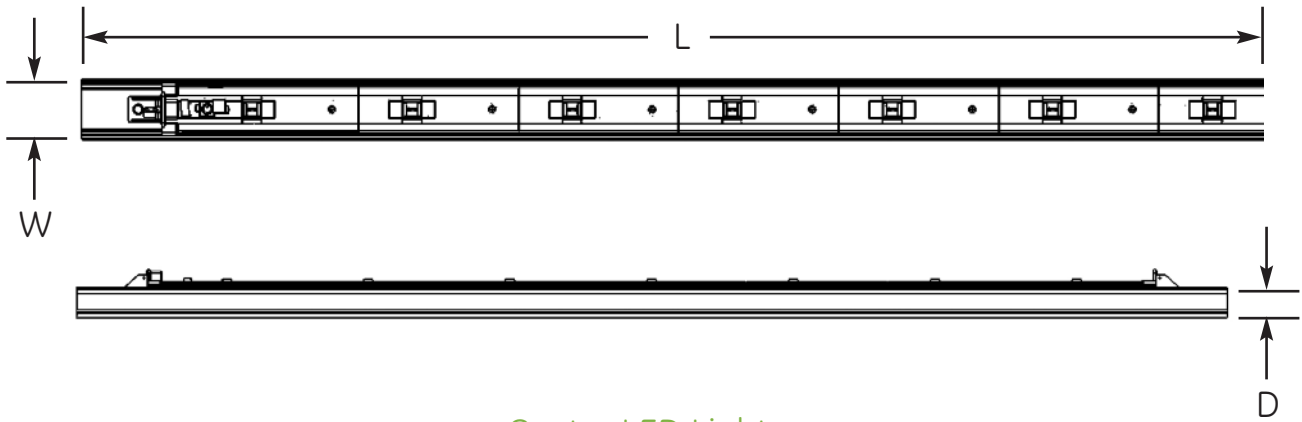

Center LED Lights

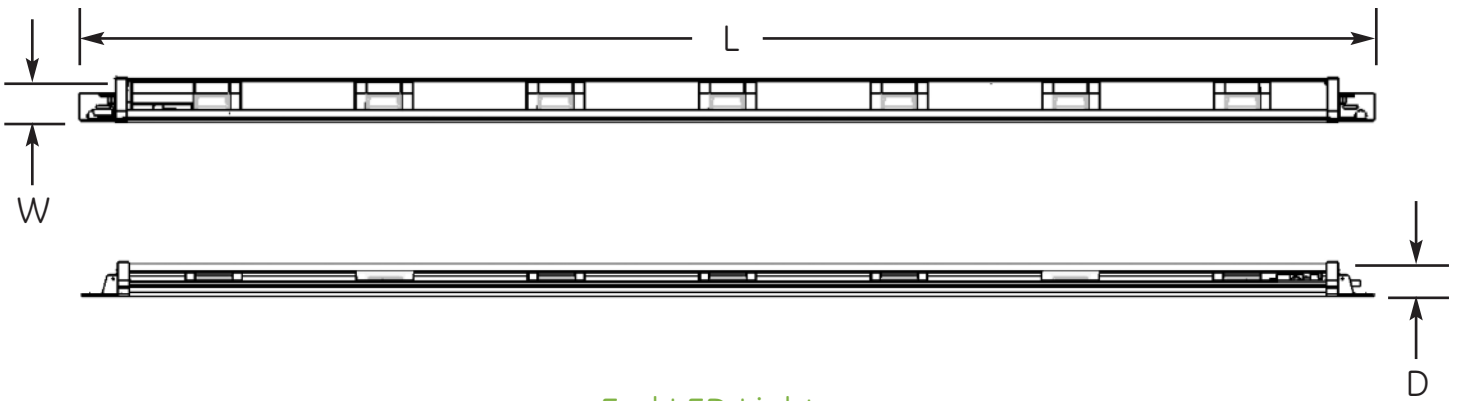

End LED Lights

	Product Code (Single)	Product Code (10-Pack)	Product Description	Item	Color Temp (K)*	Lumens	LPW	PERFORMANCE DATA					DIMENSIONAL DATA			
								Lumens Per ft (m)	Illuminance (Lux)**	Life (Hours)	CRI (Typical)	Energy (Watts)	Length (L)	Width (W)	Depth (D)	
5000K	79741	79744	GELT406050CTR-SY, -SB	60" LED Light - Center	5000	1070	66.9	214	1040	50,000	73	16	(inch)	60.3	2.6	1.3
								702					(mm)	1532	66	33
	79742	79745	GELT406050EDR-SY, -SB	60" LED Light - Right End	5000	650	81.3	130	1100	50,000	73	8	(inch)	60.3	2.09	1.59
	79743	79746	GELT406050EDL-SY, -SB	60" LED Light - Left End	5000	650	81.3	427					(mm)	1532	53	40
	79759	79762	GELT407050CTR-SY, -SB	60" LED Light - Center	5000	1231	65	209	1040	50,000	73	19	(inch)	70.8	2.6	1.3
								685					(mm)	1798	66	33
4000K	79760	79763	GELT407050EDR-SY, -SB	60" LED Light - Right End	5000	750	75	127	1130	50,000	73	10	(inch)	70.8	2.09	1.59
	79761	79764	GELT407050EDL-SY, -SB	60" LED Light - Left End	5000	750	75	417					(mm)	1798	53	40
	79747	79750	GELT406040CTR-SY, -SB	60" LED Light - Center	4000	1070	59	213	1040	50,000	80	18	(inch)	60.3	2.6	1.3
								698					(mm)	1532	66	33
	79748	79751	GELT406040EDR-SY, -SB	60" LED Light - Right End	4000	650	72	129	1100	50,000	80	9	(inch)	60.3	2.09	1.59
	79749	79752	GELT406040EDL-SY, -SB	60" LED Light - Left End	4000	650	72	424					(mm)	1532	53	40

\*Standard ANSI Color Bins

\*\*Initial illuminance (lux) +/-15% based on typical in-store performance. 60" and 70" fixtures measured at 6" throw.

\*\*\*Data provided is subject to change at any time.

# Accessories

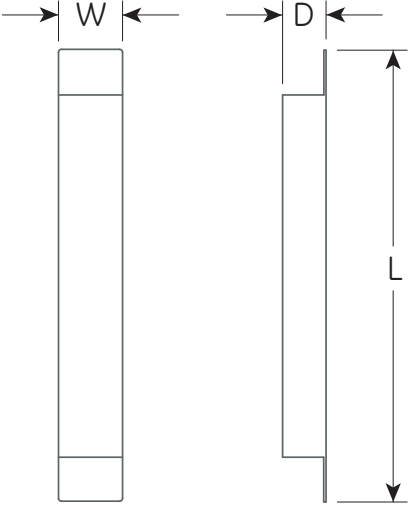

LED Driver

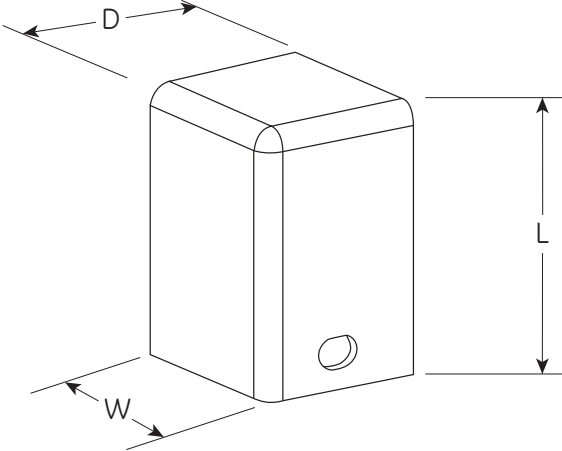

Wire Cover

Product Code (Single)	Description	Item	DIMENSIONAL DATA			
			Length (L)	Width (W)	Depth (D)	
79813	GEPS4000NCMUL-SY	LED Driver	(inch)	10.75	1.65	1.05
			(mm)	273	42	26.7
79814	GE-CV-4060CTR	Wire Cover	(inch)	1.77	1.42	1.19
			(mm)	45.01	36	30.23

# LED Driver Performance Data

79813  
GEPS4000NCMUL-SY

	Min	Typical	Max
Input Voltage (VAC)	100		240
Input Current (A)		1	
Input Line Frequency (Hz)		50/60	
60" LED Light Output Voltage (VDC)		12	
Output Power (W)			60
Max Output Current (A)		5	
Total Harmonic Distortion		N/A*	
Power Factor at >80% Load (48W @ 120 VAC, 48W @ 240VAC)	0.9		
Operating Temperature Range (°C)	-20 C		45 C
Storage Temperature Range (°C)	-40 C		70 C

Conforms to the following standards:



This device complies with Part 15 of the FCC Rules. Operation is subject to the following two conditions: (1) this device may not cause harmful interference, and (2) this device must accept any interference received, including interference that may cause undesired operation.

This Class [A] RFLD complies with the Canadian standard ICES-005.  
Ce DEFR de la classe [A] est conforme à la NMB-005 du Canada.



GE Lighting Solutions • 1-888-MY-GE-LED • [www.gelightingsolutions.com](http://www.gelightingsolutions.com)  
1 - 8 8 8 - 6 9 - 4 3 - 5 3 3

GE Lighting Solutions, LLC is a subsidiary of the General Electric Company. Immersion is a trademark of GE Lighting Solutions, LLC. The GE brand and logo are trademarks of the General Electric Company.  
© 2010 GE Lighting Solutions, LLC. Information provided is subject to change without notice. All values are design or typical values when measured under laboratory conditions.